

# The Richard Meier Collection

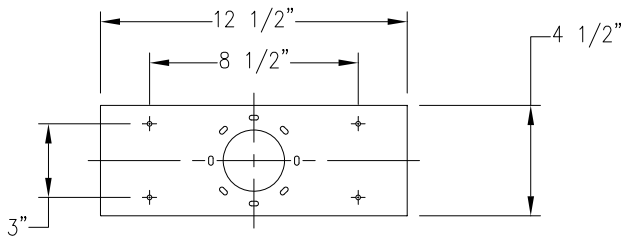

MOUNTING DETAIL

LINE OF FINISHED CEILING

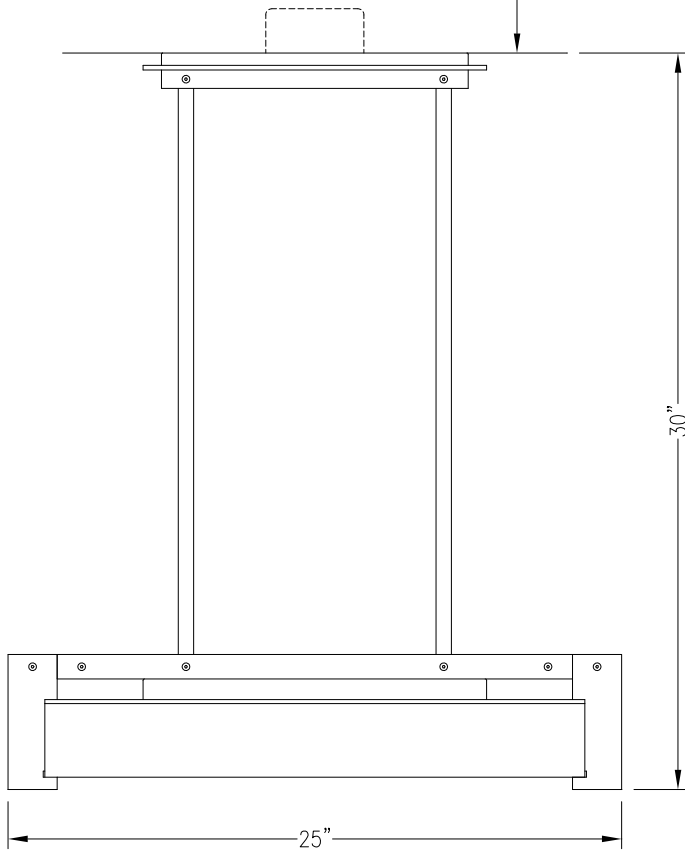

FRONT VIEW

TO BE USED WITH STANDARD 4" X 4" OCTAGONAL JUNCTION BOX (BY OTHERS)

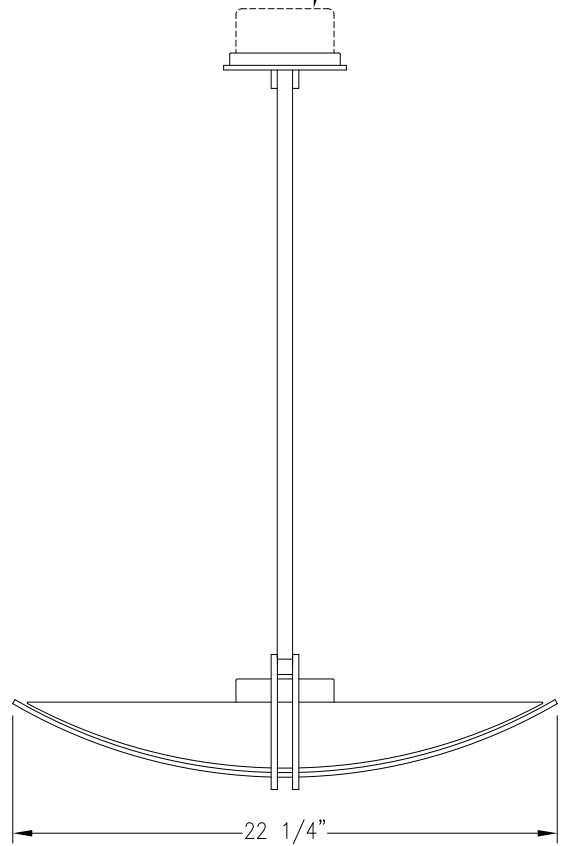

SIDE VIEW

© BALDINGER ARCHITECTURAL LIGHTING, INC.

FIXTURE WEIGHT: 30 LBS

PURCHASER: \_\_\_\_\_ DATE: 06/11/02

JOB NAME: \_\_\_\_\_ TYPE: \_\_\_\_\_ QUANTITY: \_\_\_\_\_

METAL FINISHES

- GLOSS BLACK
- GLOSS WHITE
- POLISHED BRASS
- SATIN BRASS
- POLISHED CHROME
- SATIN CHROME
- OTHER \_\_\_\_\_

DIFFUSERS

- FLASHED OPAL GLASS
- OTHER \_\_\_\_\_

LAMPING

- (4) 60W T10 (see below)
- OTHER \_\_\_\_\_

MED. BASE

VOLTAGE

- 120V  OTHER \_\_\_\_\_

JOB #:

BALDINGER

BALDINGER ARCHITECTURAL LIGHTING  
19-02 STEINWAY STREET, ASTORIA, NEW YORK 11105  
TEL. (718) 204-5700

JOSEPH  
RM30600/25  
TEL. 310 886